









LEGEND:

-  EXISTING TREE / TREE GROUP / HEDGE / SHRUB
-  T### EXISTING TREE REFERENCE NUMBER
-  G### EXISTING TREE GROUP REFERENCE NUMBER
-  H### EXISTING HEDGE REFERENCE NUMBER
-  S### EXISTING SHRUB REFERENCE NUMBER
-  ROOT PROTECTION AREA FOR EXISTING VEGETATION
-  EXISTING TREE / TREE GROUP TO BE REMOVED
-  EXISTING HEDGE / SHRUB TO BE REMOVED
-  TEMPORARY TREE PROTECTION FENCING
-  SCHEME BOUNDARY

R:\MDT0902 - Celbridge to Hazelhatch Link Road\8.0 Drawings\LA\MDT0902-RPS-01-XX-DR-Z-LA1000-LA1007 - Tree Protection and Removal.dwg

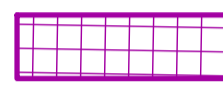
Client



General Notes

(i) Hard copies, dwf and pdf will form a controlled issue of the drawing. All other formats (dwg etc.) are deemed to be an uncontrolled issue and any work carried out based on these files is at the recipients own risk. RPS will not accept any responsibility for any errors from the use of these files, either by human error by the recipient, listing of the un-dimensioned measurements, compatibility with the recipients software, and any errors arising when these files are used to aid the recipients drawing production, or setting out on site.

(ii) DO NOT SCALE, use figured dimensions only.

(iii) This drawing is the property of RPS, it is a project confidential classified document. It must not be copied used or its contents divulged without prior written consent. The needs and expectations of client and RPS must be considered when working with this drawing.

(iv) Information including topographical survey, geotechnical investigation and utility detail used in the design have been provided by others.

(v) All Levels refer to Ordnance Survey Datum, Malin Head.

Rev	Date	Drawn By	Amendment / Issue	App
C01	28/10/25	PD	FOR PLANNING APPROVAL	



West Pier
Business Campus
Dun Laoghaire
Co Dublin

T +353 1 4882900
F +353 1 2835676
W www.rpsgroup.com/ireland
E ireland@rpsgroup.com

Scale	1:4000 @ A1 1:8000 @ A3
Created on	25/06/2024
Sheets	00 of 7

Project CELBRIDGE HAZELHATCH MOBILITY CORRIDOR		
Title TREE PROTECTION AND REMOVAL PLAN KEY PLAN & LEGEND		
Drawing Number MDT0902-RPS-01-XX-DR-Z-LA1000	Status A1	Rev C01

File Identifier
MDT0902-RPS-01-XX-DR-Z-LA1000-LA1007

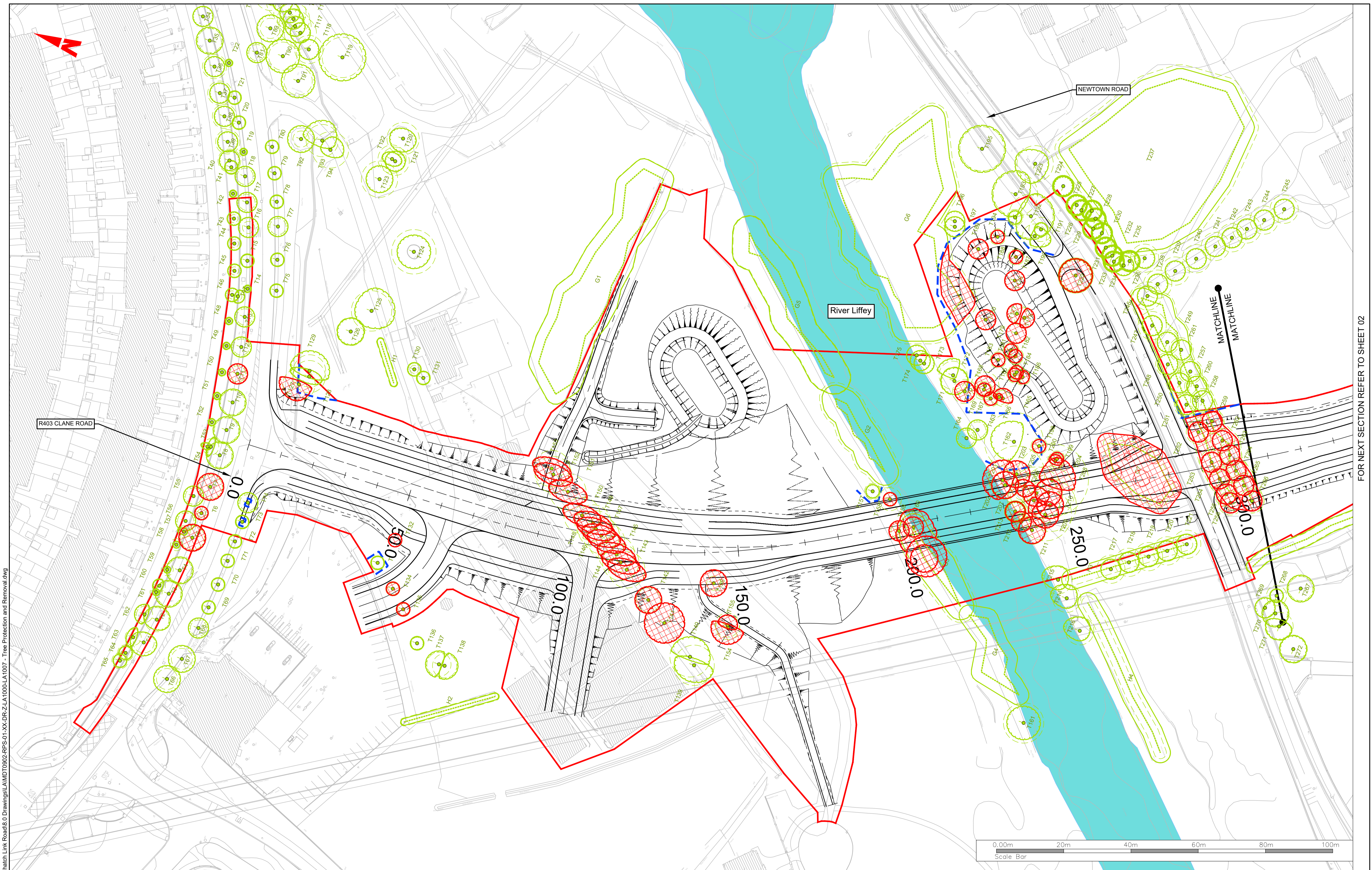

R:\MDT0902 - Celbridge to Hazelhatch Link Road\8.0 Drawings\AMMDT0902-RPS-01-XX-DR-Z-LA1000-LA1007 - Tree Protection and Removal.dwg

FOR NEXT SECTION REFER TO SHEET 02

Client

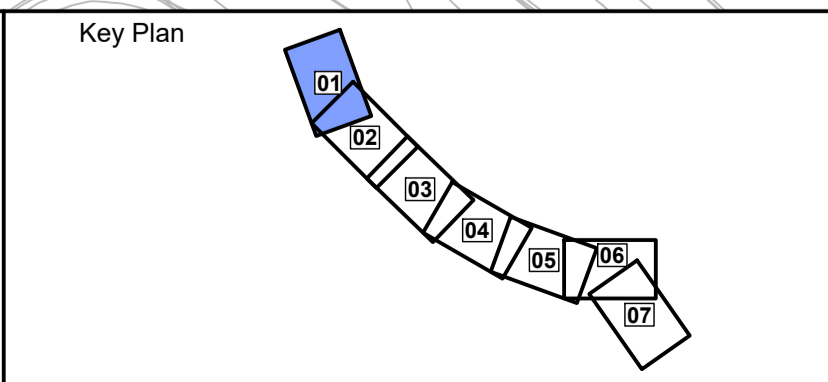
General Notes

(i) Hard copies, dxf and pdf will form a controlled issue of the drawing. All other formats (dwg etc.) are deemed to be an uncontrolled issue and any work carried out based on these files is at the recipient's own risk. RPS will not accept any responsibility for any errors from the use of these files, either by human error or by the recipient, listing of the un-dimensioned measurements, compatibility with the recipient's software, and any errors arising when these files are used to aid the recipient's drawing production, or setting out on site.

(ii) DO NOT SCALE, use figured dimensions only.

(iii) This drawing is the property of RPS, it is a project confidential classified document. It must not be copied used or its contents divulged without prior written consent. The needs and expectations of client and RPS must be considered when working with this drawing.

(iv) Information including topographical survey, geotechnical investigation and utility detail used in the design have been provided by others.

(v) All Levels refer to Ordnance Survey Datum, Malin Head.

C01	28/10/25	PD	FOR PLANNING APPROVAL	
Rev	Date	Drn Cnk	Amendment / Issue	App

rps

West Pier
Business Campus
Dun Laoghaire
Co Dublin

T +353 1 4882900
F +353 1 2835676
W www.rpsgroup.com/ireland
E ireland@rpsgroup.com

File Identifier
MDT0902-RPS-01-XX-DR-Z-LA1000-LA1007

Scale	1:500 @ A1 1:1000 @ A3
Created on	25/06/2024
Sheets	01 of 7

Project CELBRIDGE HAZELHATCH MOBILITY CORRIDOR		
Title TREE PROTECTION AND REMOVAL PLAN		
Drawing Number MDT0902-RPS-01-XX-DR-Z-LA1001	Status A1	Rev C01

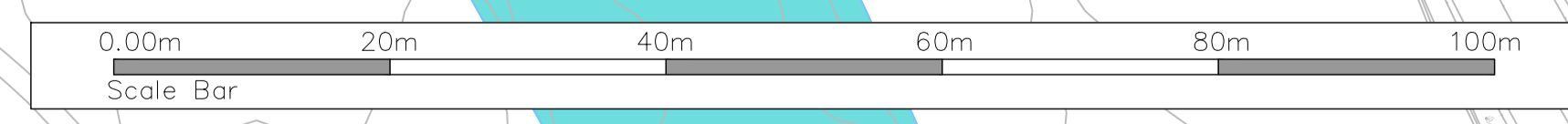

R:\MDT0902 - Celbridge to Hazelhatch Link Road\8.0 Drawings\AMDT0902-RPS-01-XX-DR-Z-LA1000-LA1007 - Tree Protection and Removal.dwg

FOR NEXT SECTION REFER TO SHEET 01

FOR NEXT SECTION REFER TO SHEET 03

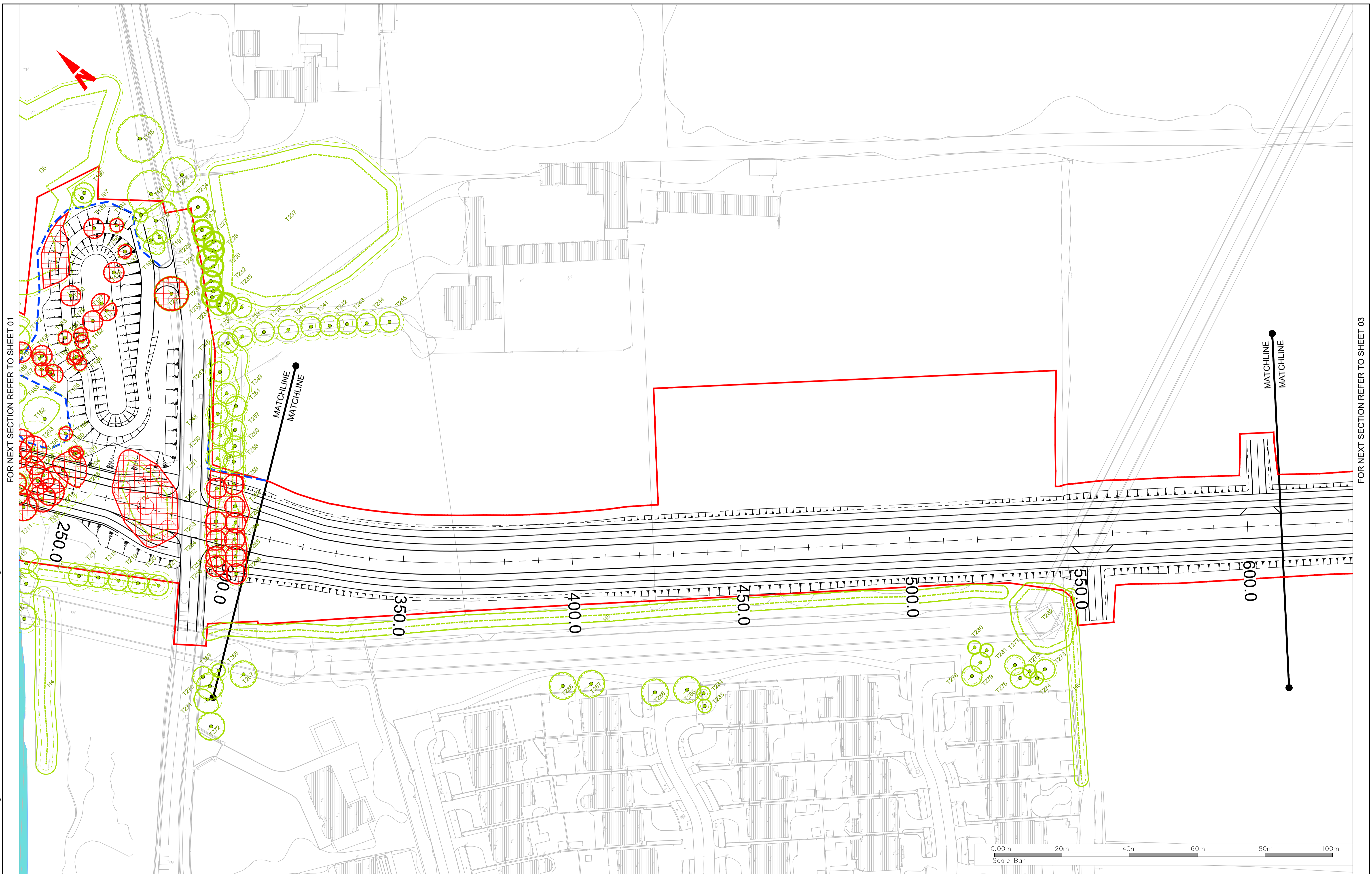

Client

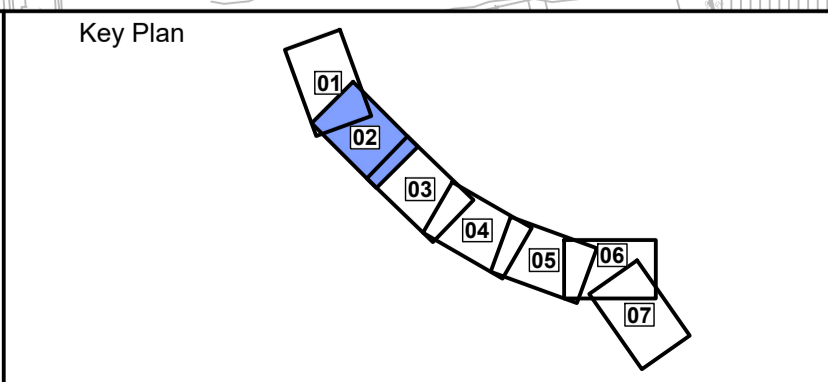

General Notes

(i) Hard copies, dwf and pdf will form a controlled issue of the drawing. All other formats (dwg etc.) are deemed to be an uncontrolled issue and any work carried out based on these files is at the recipients own risk. RPS will not accept any responsibility for any errors from the use of these files, either by human error by the recipient, listing of the un-dimensioned measurements, compatibility with the recipients software, and any errors arising when these files are used to aid the recipients drawing production, or setting out on site.

(ii) DO NOT SCALE, use figured dimensions only.

(iii) This drawing is the property of RPS, it is a project confidential classified document. It must not be copied used or its contents divulged without prior written consent. The needs and expectations of client and RPS must be considered when working with this drawing.

(iv) Information including topographical survey, geotechnical investigation and utility detail used in the design have been provided by others.

(v) All Levels refer to Ordnance Survey Datum, Malin Head.

Rev	Date	Drawn By	Amendment / Issue	App
C01	28/10/25	PD	FOR PLANNING APPROVAL	

West Pier
Business Campus
Dun Laoghaire
Co Dublin

T +353 1 4882900
F +353 1 2835676
W www.rpsgroup.com/ireland
E ireland@rpsgroup.com

Scale
1:500 @ A1
1:1000 @ A3

Created on
25/06/2024

Sheets
02 of 7

Project CELBRIDGE HAZELHATCH MOBILITY CORRIDOR		
Title TREE PROTECTION AND REMOVAL PLAN		
Drawing Number MDT0902-RPS-01-XX-DR-Z-LA1002	Status A1	Rev C01

File Identifier
MDT0902-RPS-01-XX-DR-Z-LA1000-LA1007

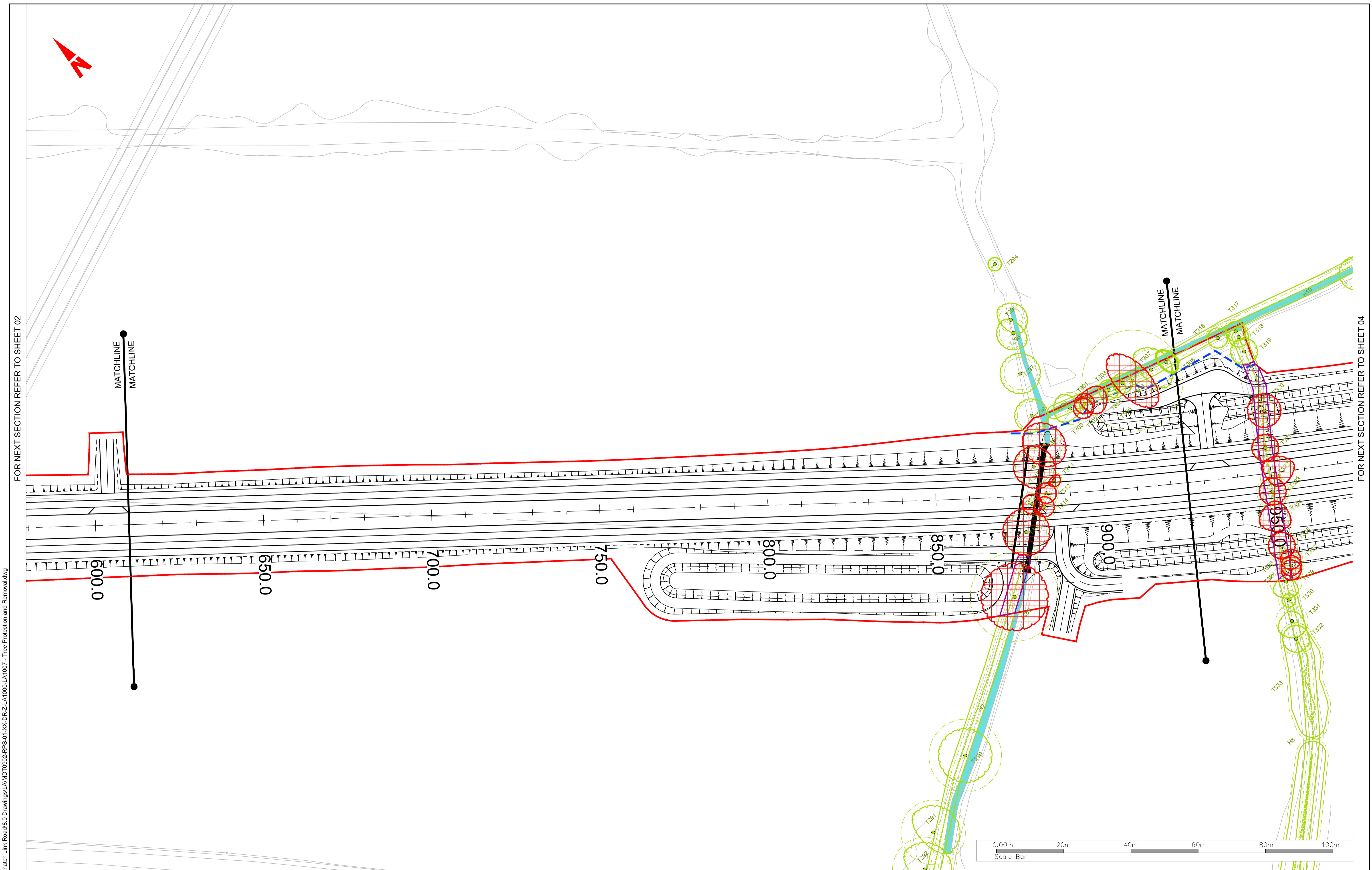

FOR NEXT SECTION REFER TO SHEET 02

FOR NEXT SECTION REFER TO SHEET 04

R:\MDT0902 - Celbridge to Hazelhatch Link Road\8.0 Drawings\LA\MDT0902-RPS-01-XX-DR-Z-LA1000-LA1007 - Tree Protection and Removal.dwg

Client

Key Plan

General Notes

(i) Hard copies, dwf and pdf will form a controlled issue of the drawing. All other formats (dwg etc.) are deemed to be uncontrolled issue and any work carried out based on these files is at the recipients own risk. RPS will not accept any responsibility for any errors from the use of these files, either by human error by the recipient, listing of the un-dimensioned measurements, compatibility with the recipients software, and any errors arising when these files are used to aid the recipients drawing production, or setting out on site.

(ii) DO NOT SCALE, use figured dimensions only.

(iii) This drawing is the property of RPS, it is a project confidential classified document. It must not be copied used or its contents divulged without prior written consent. The needs and expectations of client and RPS must be considered when working with this drawing.

(iv) Information including topographical survey, geotechnical investigation and utility detail used in the design have been provided by others.

(v) All Levels refer to Ordnance Survey Datum, Malin Head.

Rev	Date	Drawn By	Amendment / Issue	App
C01	28/10/25	PD	FOR PLANNING APPROVAL	

West Pier
Business Campus
Dun Laoghaire
Co Dublin

T +353 1 4882900
F +353 1 2835676
W www.rpsgroup.com/ireland
E ireland@rpsgroup.com

File Identifier
MDT0902-RPS-01-XX-DR-Z-LA1000-LA1007

Scale	1:500 @ A1 1:1000 @ A3
Created on	25/06/2024
Sheets	03 of 7

Project CELBRIDGE HAZELHATCH MOBILITY CORRIDOR		
Title TREE PROTECTION AND REMOVAL PLAN		
Drawing Number MDT0902-RPS-01-XX-DR-Z-LA1003	Status A1	Rev C01

FOR NEXT SECTION REFER TO SHEET 03

FOR NEXT SECTION REFER TO SHEET 05

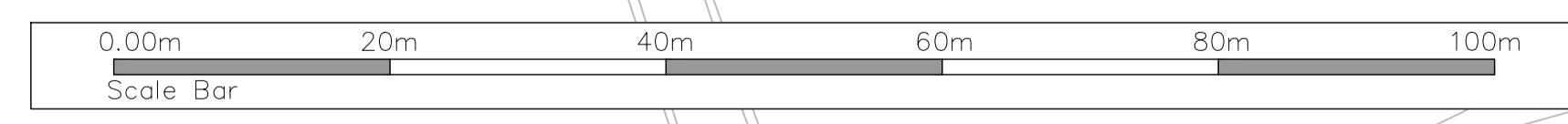
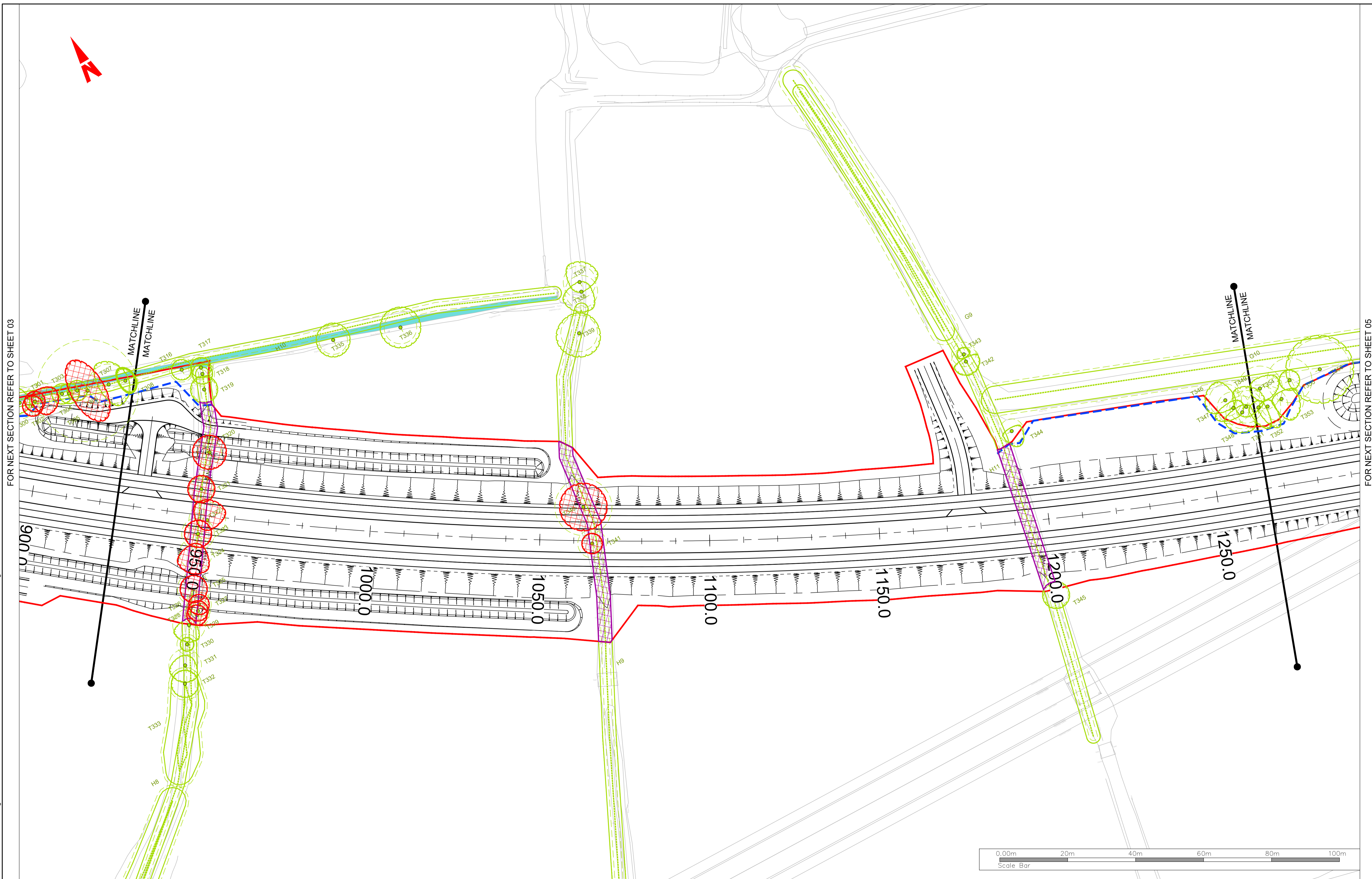

Client

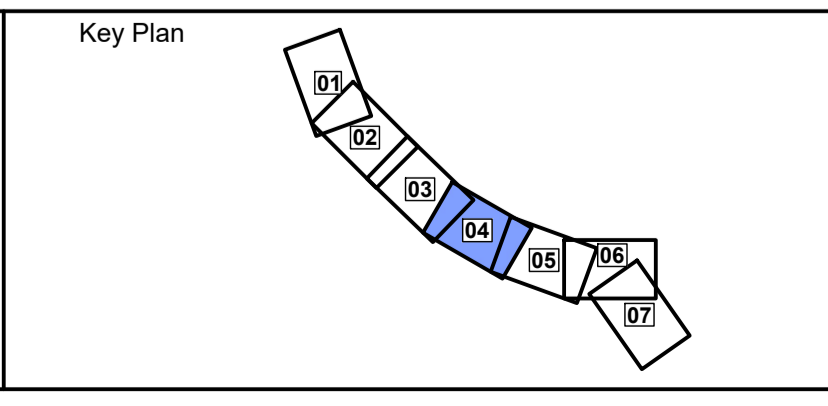

General Notes

(i) Hard copies, dwf and pdf will form a controlled issue of the drawing. All other formats (dwg etc.) are deemed to be an uncontrolled issue and any work carried out based on these files is at the recipients own risk. RPS will not accept any responsibility for any errors from the use of these files, either by human error by the recipient, listing of the un-dimensioned measurements, compatibility with the recipients software, and any errors arising when these files are used to aid the recipients drawing production, or setting out on site.

(ii) DO NOT SCALE, use figured dimensions only.

(iii) This drawing is the property of RPS, it is a project confidential classified document. It must not be copied used or its contents divulged without prior written consent. The needs and expectations of client and RPS must be considered when working with this drawing.

(iv) Information including topographical survey, geotechnical investigation and utility detail used in the design have been provided by others.

(v) All Levels refer to Ordnance Survey Datum, Malin Head.

Rev	Date	Dim Cmk	Amendment / Issue	App
C01	28/10/25	pd	FOR PLANNING APPROVAL	

West Pier
Business Campus
Dun Laoghaire
Co Dublin

T +353 1 4882900
F +353 1 2835676
W www.rpsgroup.com/ireland
E ireland@rpsgroup.com

Scale	1:500 @ A1 1:1000 @ A3
Created on	25/06/2024
Sheets	04 of 7

Project CELBRIDGE HAZELHATCH MOBILITY CORRIDOR		
Title TREE PROTECTION AND REMOVAL PLAN		
Drawing Number MDT0902-RPS-01-XX-DR-Z-LA1004	Status A1	Rev C01

R:\MDT0902 - Celbridge to Hazelhatch Link Road\8.0 Drawings\LA\MDT0902-RPS-01-XX-DR-Z-LA1000-LA1007 - Tree Protection and Removal.dwg

FOR NEXT SECTION REFER TO SHEET 04

FOR NEXT SECTION REFER TO SHEET 06



Client

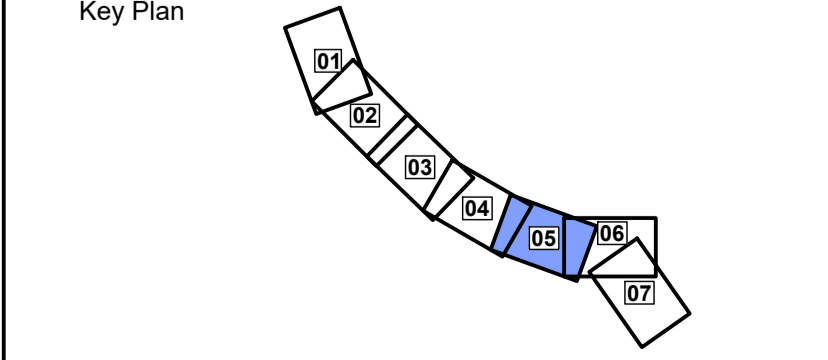

General Notes

(i) Hard copies, dwf and pdf will form a controlled issue of the drawing. All other formats (dwg etc.) are deemed to be an uncontrolled issue and any work carried out based on these files is at the recipients own risk. RPS will not accept any responsibility for any errors from the use of these files, either by human error by the recipient, listing of the un-dimensioned measurements, compatibility with the recipients software, and any errors arising when these files are used to aid the recipients drawing production, or setting out on site.

(ii) DO NOT SCALE, use figured dimensions only.

(iii) This drawing is the property of RPS, it is a project confidential classified document. It must not be copied used or its contents divulged without prior written consent. The needs and expectations of client and RPS must be considered when working with this drawing.

(iv) Information including topographical survey, geotechnical investigation and utility detail used in the design have been provided by others.

(v) All Levels refer to Ordnance Survey Datum, Malin Head.

Rev	Date	Drawn By	Amendment / Issue	App
C01	28/10/25	PD	FOR PLANNING APPROVAL	

West Pier
Business Campus
Dun Laoghaire
Co Dublin

T +353 1 4882900
F +353 1 2835676
W www.rpsgroup.com/ireland
E ireland@rpsgroup.com

File Identifier
MDT0902-RPS-01-XX-DR-Z-LA1000-LA1007

Scale	1:500 @ A1 1:1000 @ A3
Created on	25/06/2024
Sheets	05 of 7

Project CELBRIDGE HAZELHATCH MOBILITY CORRIDOR		
Title TREE PROTECTION AND REMOVAL PLAN		
Drawing Number MDT0902-RPS-01-XX-DR-Z-LA1005	Status A1	Rev C01

R:\MDT0902 - Celbridge to Hazelhatch Link Road\8.0 Drawings\LA\MDT0902-RPS-01-XX-DR-Z-LA1000-LA1007 - Tree Protection and Removal.dwg

FOR NEXT SECTION REFER TO SHEET 05

FOR NEXT SECTION REFER TO SHEET 07

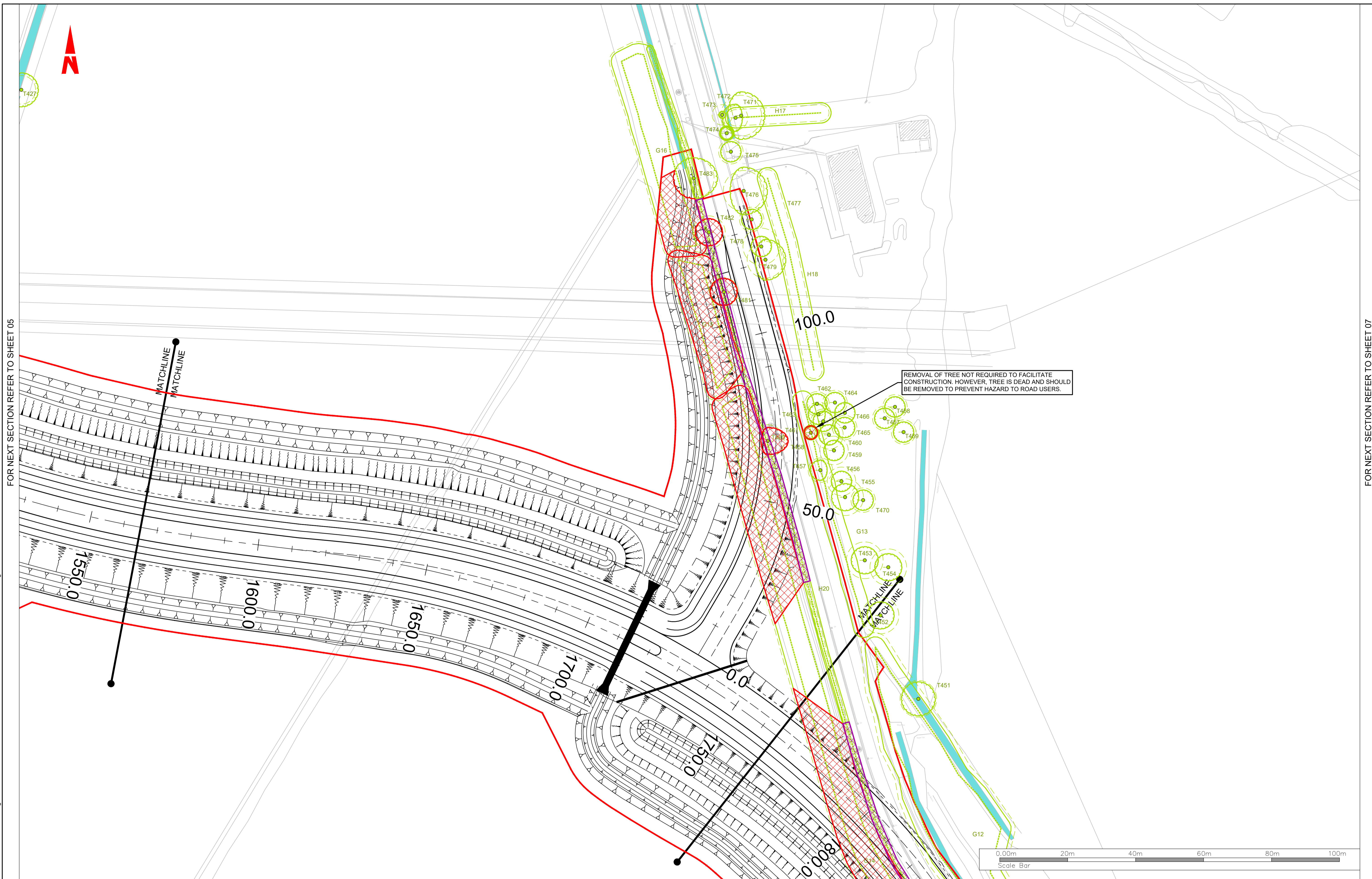

R:\MDT0902 - Celbridge to Hazelhatch Link Road\8.0 Drawings\LA\MDT0902-RPS-01-XX-DR-Z-LA1000-LA1007 - Tree Protection and Removal.dwg

Client

Key Plan

General Notes

(i) Hard copies, dwf and pdf will form a controlled issue of the drawing. All other formats (dwg etc.) are deemed to be an uncontrolled issue and any work carried out based on these files is at the recipients own risk. RPS will not accept any responsibility for any errors from the use of these files, either by human error by the recipient, listing of the un-dimensioned measurements, compatibility with the recipients software, and any errors arising when these files are used to aid the recipients drawing production, or setting out on site.

(ii) DO NOT SCALE, use figured dimensions only.

(iii) This drawing is the property of RPS, it is a project confidential classified document. It must not be copied used or its contents divulged without prior written consent. The needs and expectations of client and RPS must be considered when working with this drawing.

(iv) Information including topographical survey, geotechnical investigation and utility detail used in the design have been provided by others.

(v) All Levels refer to Ordnance Survey Datum, Malin Head.

Rev	Date	Drawn	Checked	Amendment / Issue	App
C01	28/10/25	PD		FOR PLANNING APPROVAL	

rps

West Pier
Business Campus
Dun Laoghaire
Co Dublin

T +353 1 4882900
F +353 1 2835676
W www.rpsgroup.com/ireland
E ireland@rpsgroup.com

File Identifier
MDT0902-RPS-01-XX-DR-Z-LA1000-LA1007

Scale	1:500 @ A1 1:1000 @ A3
Created on	25/06/2024
Sheets	06 of 7

Project CELBRIDGE HAZELHATCH MOBILITY CORRIDOR		
Title TREE PROTECTION AND REMOVAL PLAN		
Drawing Number MDT0902-RPS-01-XX-DR-Z-LA1006	Status A1	Rev C01

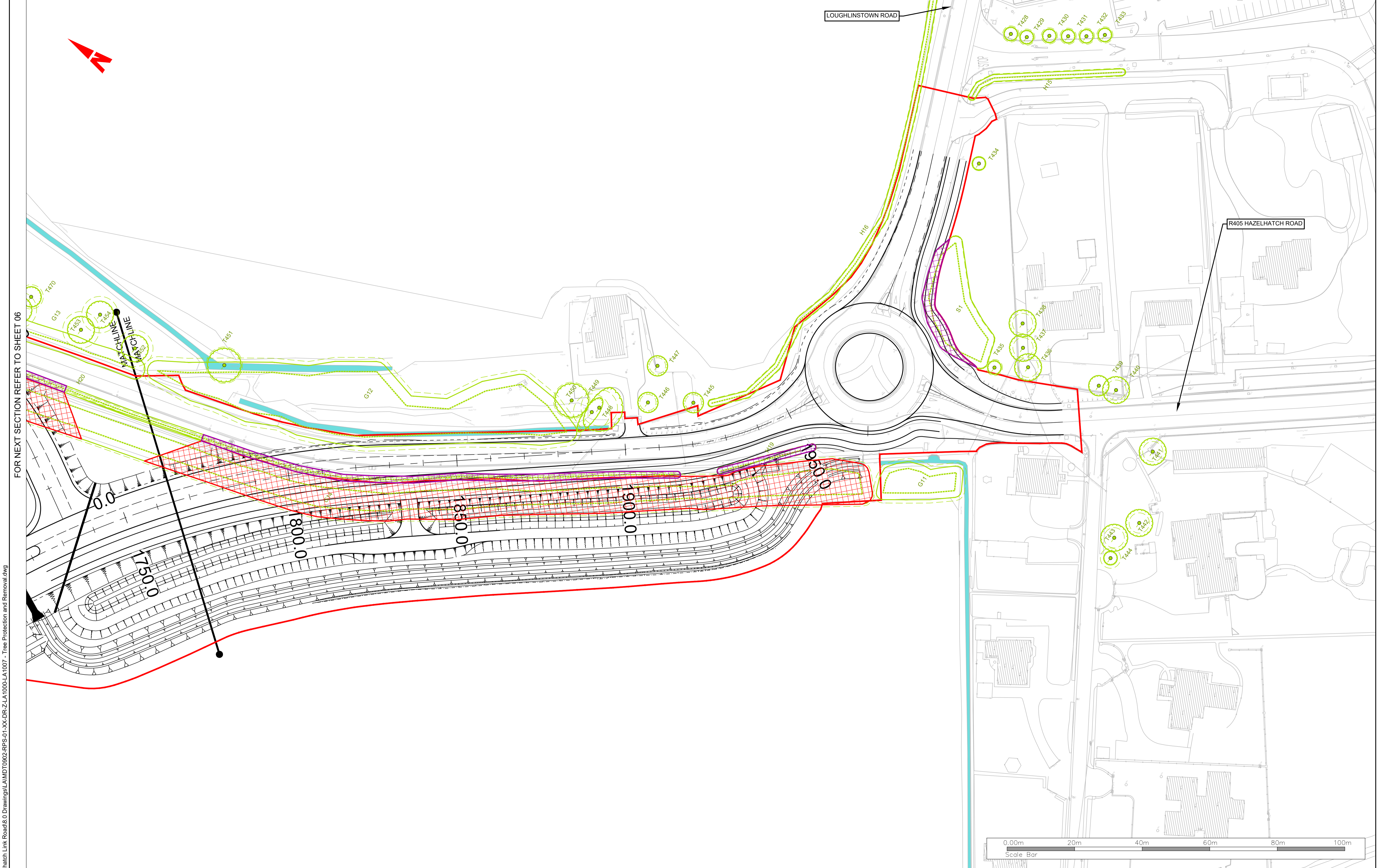

FOR NEXT SECTION REFER TO SHEET 06

R:\MDT0902 - Celbridge to Hazelhatch Link Road\8.0 Drawings\LA\MDT0902-RPS-01-XX-DR-Z-LA1000-LA1007 - Tree Protection and Removal.dwg

Client

Key Plan

General Notes

(i) Hard copies, dwf and pdf will form a controlled issue of the drawing. All other formats (dwg etc.) are deemed to be an uncontrolled issue and any work carried out based on these files is at the recipients own risk. RPS will not accept any responsibility for any errors from the use of these files, either by human error by the recipient, listing of the un-dimensioned measurements, compatibility with the recipients software, and any errors arising when these files are used to aid the recipients drawing production, or setting out on site.

(ii) DO NOT SCALE, use figured dimensions only.

(iii) This drawing is the property of RPS, it is a project confidential classified document. It must not be copied used or its contents divulged without prior written consent. The needs and expectations of client and RPS must be considered when working with this drawing.

(iv) Information including topographical survey, geotechnical investigation and utility detail used in the design have been provided by others.

(v) All Levels refer to Ordnance Survey Datum, Malin Head.

Rev	Date	Drawn By	Amendment / Issue	App
C01	28/10/25	PD	FOR PLANNING APPROVAL	

West Pier
Business Campus
Dun Laoghaire
Co Dublin

T +353 1 4882900
F +353 1 2835676
W www.rpsgroup.com/ireland
E ireland@rpsgroup.com

Scale
1:500 @ A1
1:1000 @ A3

Created on
25/06/2024

Sheets
07 of 7

Project CELBRIDGE HAZELHATCH MOBILITY CORRIDOR		
Title TREE PROTECTION AND REMOVAL PLAN		
Drawing Number MDT0902-RPS-01-XX-DR-Z-LA1007	Status A1	Rev C01