

- NOTES:
- DO NOT SCALE. USE FIGURED DIMENSIONS ONLY.
 - THIS DRAWING IS TO BE READ IN CONJUNCTION WITH ALL OTHER RELEVANT ARCHITECTURAL AND ENGINEERING DRAWINGS.
 - SUDS FEATURES TO COMPLY WITH CIRIA SUDS MANUAL
 - SPECIALIST PLANTING TO SUDS ELEMENTS TO BE SELECTED BY SUITABLY QUALIFIED LANDSCAPE ARCHITECT.
 - SUDS DETAILS REFER TO LANDSCAPE ARCHITECT LAYOUT.

LEGEND

EX XXX@ 1/XXX	EXISTING SURFACE WATER SEWER WITH PIPE SIZE, GRADE, MANHOLE REF. AND INVERT LEVEL
XXX@ 1/XXX	PROPOSED SURFACE WATER SEWER WITH PIPE SIZE, GRADE, INSPECTION CHAMBER 0.8m DEEP
XXX@ 1/XXX	PROPOSED PERFORATED SURFACE WATER SEWER
G	EXISTING GULLY

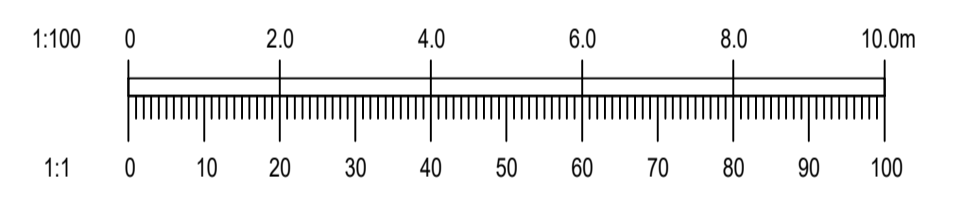
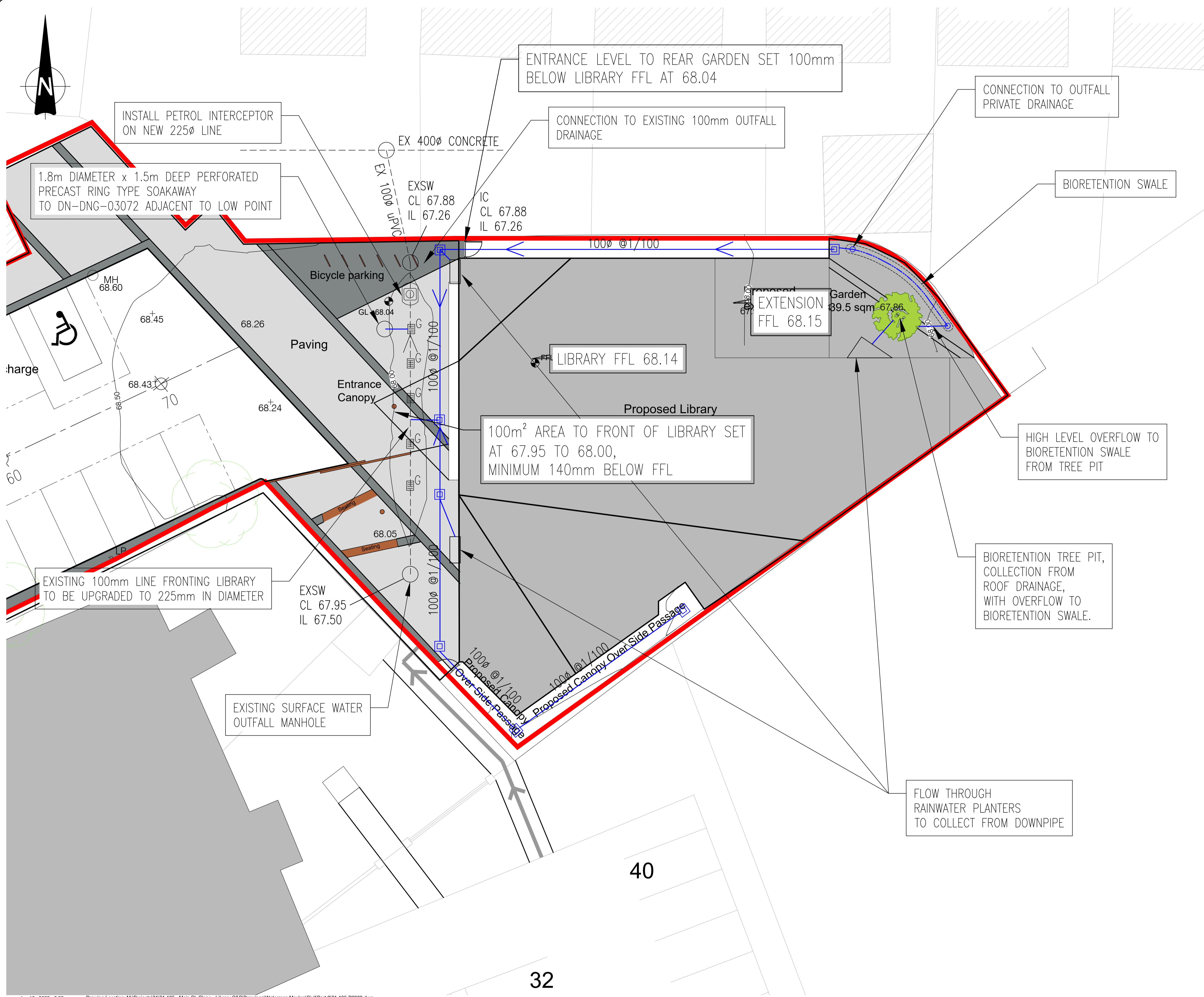

Ordnance Survey Ireland Licence No. EN 0006022
© Ordnance Survey Ireland/Government of Ireland.

REV.	DATE	AMENDMENT	DRN	APPD

STATUS **PUBLIC DISPLAY - DRAFT**

Waterman Moylan
Engineering Consultants

BLOCK 5, EASTPOINT BUSINESS PARK, ALFIE BYRNE ROAD,
DUBLIN D03 K7W7 IRELAND.
Tel: (01) 664 8900 Fax: (01) 661 3618
Email: info@waterman-moylan.ie www.waterman-moylan.ie

CLIENT **KILDARE LIBRARY SERVICES**

ARCHITECT **DEATON LYSAGHT ARCHITECTS**

PROJECT
PROPOSED LIBRARY SERVICE AT UNITS 8 AND 9, THE VILLAGE CENTRE, MAIN STREET, CLANE, CO. KILDARE

TITLE
SURFACE WATER SUDS STRATEGY

DRAWN MS	DESIGNED RM	APPROVED MD	DATE MAY 2022
SCALE 1:100 @ A1	JOB NO. 21-105	DRG. NO. P2000	REVISION